*Using your
LED Plus
keypad*

System 236

System 236i

Congratulations

Thank you for purchasing this C&K alarm system. Your system is one of the most powerful and advanced alarm systems on the market today, designed to provide you with years of reliable operation.

This manual explains how to operate your alarm system. Basic operating instructions are also printed on the label inside your keypad(s) door.

If you have any questions or need help with your alarm system, call:

If you have monitoring questions or in cases of accidental alarms, call:

(Alarm Company Name)



(Monitoring Station Name)



When calling the monitoring company, know the following:

My Account Number is: _____

My Password is: _____

Table of contents

Getting acquainted	4-5	Door chime / Keypad tones	23-24
What the lights mean	6-7	Testing your system	25-27
What the sounds mean	8	Telephone trouble	28
Arming the system	9-15	Smoke detector placement	29
Bypassing zones	14-15	Emergency evacuation	30
Arming options	16	Definitions	31
Disarming the system	17	Limitations of your alarm system	32
After an alarm	18	Keypad operations	33-35
Options	19-24	Test Procedure Index	36
Changing a PIN	20-21	Zone description list	37
Deleting a PIN	21	FCC Notice	38
Resetting smoke detectors	22	Industry Canada	39

Getting acquainted

What your alarm system is...

Your alarm system is made up of a control panel and several detection devices like motion sensors, magnetic contacts, and so on. Specific areas of detection are called zones. Zones can be programmed to have different characteristics. Some zones may be 24-hour zones, that is, they remain armed even when the alarm system is off. Zones used for fire detection, for example, are always 24-hour zones. In addition, some zones can be programmed to allow bypassing. When you bypass a zone, you temporarily remove it from the alarm system. **Always remember, however, that bypassed zones are not protected.**

How your alarm system works...

When a detection device is triggered, the status of its zone goes from normal to FAULTED. If armed, the control panel responds by reporting an alarm condition on site --- flashing keypad lights, sounding bells --- and if programmed, by transmitting an alarm signal over the telephone wires to a central monitoring station. The monitoring station then dispatches the appropriate authorities.

Some of your system's operations require you to enter your personal identification number (PIN) on the keypad. These include ARMING and DISARMING.

Along with its many other features, your system can be programmed to ARM INSTANTLY or to ARM WITH TIME DELAY (i.e., after giving you time to leave the premises).

Getting acquainted

Each alarm system in the 23XX family is designed to meet the specific needs of a variety of applications. The System 236 is designed for applications requiring protection of six zones.

Some of the available features of your alarm system are also optional, and will only be installed if appropriate for your installation. In addition, some system features will require you to enter your personal identification number (PIN).

As you read through this manual, watch for boxes like these:

- If an optional feature has been installed in your system, its **OPTION INSTALLED** box will be checked.
- If a feature of your system requires you to enter your personal identification number, its **PIN REQUIRED** box will be checked.

OPTION
INSTALLED



PIN
REQUIRED



What the lights mean

	POWER LIGHT	READY LIGHT	ARMED LIGHT	SERVICE LIGHT	ZONES LIGHTS	REMARKS
AC FAILURE	off			onsteady		Power fail. System on battery.
SYSTEM IS READY (ALL ZONES NORMAL)		onsteady				Ready to arm.
FAULTED ZONE WHILE DISARMED		off			onsteady	One or more zones are faulted.
SYSTEM IS ARMED (ALL PROTECTION ON)		off*	onsteady			*Ready light will be on until system is armed.
SYSTEM IS DISARMED (ALL PROTECTION OFF)		on*	off			*Ready light is on if all zones are normal.
SYSTEM IS ARMED WITH DELAY ZONES CONVERTED TO INSTANT		off	slow flash			Armed with * 7 #.
PERIMETER ARMED WITH DELAYS INTACT		slow flash	onsteady		slow flash*	Armed with * 4 #. *Flashing zones are bypassed.

What the lights mean

	POWER LIGHT	READY LIGHT	ARMED LIGHT	SERVICE LIGHT	ZONES LIGHTS	REMARKS
PERIMETER ARMED WITH DELAY ZONES CONVERTED TO INSTANT		slow flash	slow flash		slow flash*	Armed with* 4 7 #. *Flashing zones are bypassed.
ZONE TROUBLE				slow flash	slow flash	Service and zone in trouble. Flash at the same rate.
ZONE(S) IS OR WAS IN ALARM		slow flash	on*		fast flash	An alarm has occurred on this zone. *Armed light is on if the system is armed.
ZONE BYPASSED		slow flash			slow flash	Ready and bypassed zone flash at the same rate.
LOW BATTERY	slow flash			on steady		Call for service.
BELL FUSE FAILURE				on steady		Call for service.
WATCHDOG RESET				slow flash		Panel has reset itself. System OK. To reset the Service Light, press * 1 #.
COMMUNICATIONS FAILURE				fast flash		Call for service.
PROGRAMMING MODE		slow flash	slow flash	slow flash		System is in programming mode.

What the sounds mean

SOUND	MEANING
2 beeps (confirmation tones)	<ul style="list-style-type: none">• system armed or disarmed• successful central station test or battery test
5 beeps (error tones)	<ul style="list-style-type: none">• wrong PIN number entered• invalid function• unauthorized command attempted• error changing PIN number
continuous tone, beeping fast for last ten seconds	<ul style="list-style-type: none">• entry delay time
continuous beeping, speeding up for last ten seconds	<ul style="list-style-type: none">• exit delay time
2 second beep	<ul style="list-style-type: none">• door chime• zone faulted during walk-test
chirping (1 second on, 4 seconds off)	<ul style="list-style-type: none">• zone programmed for chirping bell or siren is in alarm
continuous tone	<ul style="list-style-type: none">• zone programmed for steady bell or siren is in alarm• circuit malfunction (trouble on supervised loops only)
pulsed tone (2 seconds on, 2 seconds off)	<ul style="list-style-type: none">• zone programmed for pulsed bell or siren is in alarm

Arming the system

TO ARM THE SYSTEM / AUTO HOME ARMING:

1 Make sure the green READY light is on.

- Faulted zones must be cleared or bypassed before the system can be armed. For more information, refer to the sections [Bypassing Zones](#) and [After An Alarm Occurs](#).
- If programmed, the red ZONE lights will automatically turn off after five minutes (as a security measure). Pressing any key on the keypad will turn the ZONE lights back on.

OPTION
INSTALLED



PIN
REQUIRED



2 Enter your PIN and push the # key.



- Your PIN number is four digits long.
- Don't pause for more than 5 seconds while entering the digits or the control panel will reject your PIN number.
- If you make a mistake while entering your PIN number, the keypad will beep five times. After the fifth beep, enter your PIN number again.

3 Make sure the red ARM light comes on.

- The keypad will beep twice to confirm that the system is armed.

Arming the system

4 Exit through any TIME DELAY DOOR within _____ seconds.

- The exit delay time can be programmed from 10 seconds to 150 seconds.
- If the EXIT PRE-ALARM option is installed, the keypad will beep slowly until 10 seconds before the delay time expires, then rapidly for the last 10 seconds.
- Once the exit delay time has expired, the keypad will beep twice to confirm that the system is armed.

OPTION
INSTALLED

OPTION
INSTALLED

The **AUTO HOME ARMING** option enables the system to automatically bypass interior zones if you arm the system but do not leave the premises. The perimeter zones will be armed and the entry delay will remain intact.

With this option installed, arm the system (enter your PIN and push the # key).

- If you do not exit before the exit delay time expires, the system will automatically arm perimeter zones and bypass interior zones.
- If you exit through an exit delay door, the system will automatically arm interior and perimeter zones.

The rest of the ARMING THE SYSTEM section explains how to bypass zones before arming the system, as well as certain arming options our installer can install. However, it's important for you to remember that no matter how your system is programmed, **you will always disarm it in the same way: enter your PIN, then push the # key.**

Arming the system

INSTANT ARMING

Instant Arming converts all time delayed zones to **INSTANT** zones.

1 Make sure the green **READY** light is on.

PIN
REQUIRED

2 Enter your PIN (*if required*),
push the * key, enter the digit "7",
then push the # key.

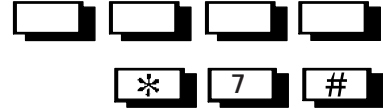

- The keypad will beep twice to confirm that the system is armed.
- The red **ARM** light will flash while the system is Instant Armed.



CAUTION: When the system is Instant Armed, you will not be able to enter through any perimeter door or walk through any protected area without setting off an alarm.

- Home Arming or bypassing interior zones will allow you to move about freely inside the premises while the system is armed. Refer to the next three sections: **HOME ARMING**, **INSTANT HOME ARMING**, and **BYPASSING ZONES**.
- Exit Delay Disable (see page 16).

OPTION
INSTALLED

Arming the system

HOME ARMING

Home Arming arms perimeter zones, while bypassing interior zones.

1 Make sure the green READY light is on.

PIN
REQUIRED

2 Enter your PIN (*if required*),
push the * key, enter the digit "4",
then push the # key.

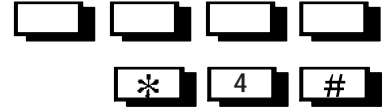

- The keypad will beep twice to confirm that the system is armed.
- The red ARM light will be on while the system is armed.
- Home Arming allows you to move about freely inside the premises while the system is armed.
- The red ZONE light(s) of bypassed zones will flash slowly.
- You can enter the premises without setting off an alarm through any time delay entry. (Don't forget to disarm the system after entering!)
- Exit Delay Disable (see page 16).

OPTION
INSTALLED

Arming the system

INSTANT HOME ARMING

Instant Home Arming arms the perimeter zones and bypasses interior zones. Entry time delays are converted to INSTANT.

1 Make sure the green READY light is on.



2 Enter your PIN (if required), push the * key, enter the digit "7", the digit "4", then push the # key.



OR



- The keypad will beep twice to confirm that the system is armed.
- The red ARM light will flash while the perimeter zones are Instant Armed.
- The red ZONE light(s) of bypassed zones will flash slowly.



CAUTION: When the system is Instant Home Armed, you will not be able to enter through any perimeter door without setting off an alarm.

- Exit Delay Disable (see page 16).

PIN
REQUIRED

OPTION
INSTALLED

Arming the system

BYPASSING ZONES

This procedure allows you to bypass one or more zones while your system is DISARMED¹. (See NOTE pg. 15)

 **NOTE:** System programming determines which PINs can bypass zones, also which zones can be bypassed. To learn if a zone can be bypassed, see the ZONE DESCRIPTION LIST on page 37.

PIN
REQUIRED

1

Enter your PIN (*if required*).



OPTION
INSTALLED

2a

Push the * key, enter the digit "2", enter the zone to be bypassed, then push the # key.



OR

OPTION
INSTALLED

2b

Push the  key, enter the zone to be bypassed, then push the # key.



Arming the system

- To indicate that zones are bypassed, the zone LED for the bypassed zone will flash slowly.
- **NOTE:** Zones can be also be bypassed by remote programming. When remote programming is used, the system can either be armed or disarmed.
- The procedures for adding a bypass and removing a bypass are identical.
- To remove a bypass:

1a Enter your PIN, push the * key, enter the digit "2", enter the zone from which the bypass is to be removed, then push the # key.

OR

1b Enter your PIN, push the  key, enter the zone from which the bypass is to be removed, then press the # key.



NOTE: Disarming your alarm system **REMOVES** all bypasses.

Arming options

Your alarm system has been programmed for one of the following two arming types:

OPTION
INSTALLED

GOOF-PROOF ARMING

If any zone other than a 24-hour zone is faulted (open window, malfunctioning sensor, etc.), your system will not arm. You will not be able to arm the system until the faulted zone is cleared or manually bypassed.

OPTION
INSTALLED

FORCE ARMING

Any zone (except for 24-hour zones) that is violated during the EXIT DELAY time will automatically be bypassed until the system is disarmed.



Warning: bypassed zones are not protected.

OPTION
INSTALLED

EXIT DELAY DISABLE

If this option is installed, the exit delay will be eliminated when arming your system using Instant Arming (page 11), Home Arming (page 12), or Instant Home Arming (page 13).

Disarming the system

TO DISARM THE SYSTEM:

1 Enter only through a TIME DELAY door.

- If the ENTRY PRE-ALARM option is installed, the keypad will sound constantly until 10 seconds before the delay time expires (or the panel is disarmed), then beep rapidly for the last 10 seconds.

OPTION
INSTALLED

2 Enter your PIN within _____ seconds and push the # key.



PIN
REQUIRED



3 Make sure the red ARM light on the keypad goes off.

- If the ARM light does not go off, wait for the keypad to beep five times, then enter your PIN again.
- The keypad will beep twice to confirm that the system has been disarmed.
- All bypasses are removed.

After an alarm

AFTER AN ALARM OCCURS:



- 1 Enter your PIN and push the # key.



- This will silence the bell/siren and disarm the system.
- The red ZONE lights on the keypad will flash fast to help you remember where the violations occurred.

- 2 If this is a false alarm and no emergency response is needed, call our central station IMMEDIATELY at  _____ to cancel the alarm.

- Write down the number of the faulted zones to help us service you.

- 3 Clear the alarm memory and red ZONE lights by pushing the * key, entering the digit "1", then pushing the # key.

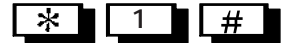

OPTION
INSTALLED

24-HOUR MONITORING

With this option installed, your alarm system will transmit alarm signals to our central station.

OPTION
INSTALLED

POLICE/PANIC KEY

When this option is installed, holding down the  key for three seconds will trigger an alarm. The keypad will beep twice to confirm the alarm condition.



OPTION
INSTALLED

DURESS ALARM (Available on Systems 236i ONLY)

Should an intruder force you to turn your security system on or off, you can send a silent DURESS signal to our central station by entering **User Code 6** - a code designated exclusively for a DURESS signal. Your system will appear to be operating normally. There is no indication of an alarm condition.

Options

CHANGING A SYSTEM 236 USER PIN

User 1 can use his Master PIN to change the PINs of Users 1 - 6.

MASTER PIN
REQUIRED



- 1 Enter your Master PIN, push the * key, enter the digit "0", then push the # key.

- The READY, SERVICE, and ARM lights will flash slowly.

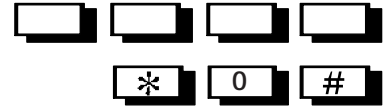

- 2 Enter the User number (1 - 6), and push the # key.



- 3 Enter that User's new PIN and push the # key.

- The new PIN must be four digits long.



4 Enter the new PIN again and push the # key.



- If the new PIN is accepted, the keypad will beep twice. If you make a mistake while programming, or if the system rejects the new PIN, the keypad will beep five times. Try again.
- If no key is pressed for 5 minutes, the system will automatically exit the programming mode.

5 Exit the programming mode by pushing the * key, then the # key.



6 Make sure the new PIN works.

After leaving the programming mode, Arm and Disarm your system to ensure that the new PIN functions properly.

DELETING A SYSTEM 236 USER PIN

User 1 can use his Master PIN to delete the PINs of Users 2 - 6. Follow steps 1 through 4 for Changing a User PIN. In steps 3 and 4 enter four zeros in place of a new PIN.

Options

OPTION
INSTALLED



RESETTING SMOKE DETECTORS

When a smoke detector is triggered, the red ZONE light of the zone where it's located will come on, and the bell/siren will sound.

Before you do anything else, evacuate the building. Don't go back inside until you are sure it's safe. When it's safe to do so, you can reset the smoke detectors by doing the following:

Push the * key, enter the digit "6",
the digit "2", and push the # key.



OPTION
INSTALLED



STANDBY BATTERY

Should there be a loss of AC power, the green POWER light on the keypad will go out, and your alarm system will switch to its standby battery. If an AC power failure lasts for more than 15 minutes, the system will send a signal to the central station (if programmed to do so).

- **The standby battery should be replaced every four to six years** with a rechargeable 12 V 6.5 Ah sealed lead-acid battery (such as C&K Model 1265).

OPTION
INSTALLED



DOOR CHIME

When this option is installed, the keypad will beep for two seconds each time a designated zone is faulted.

To turn the door chime on and off (for all keypads installed):

**Push the * key, enter the digit "5",
then push the # key.**

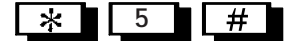

KEYPAD TONE DISABLE

You can disable the sounds the keypad makes for a variety of functions. These functions include: KEYPAD FEEDBACK (the keypad beeps everytime you press a key), EXIT PRE-ALARM tone (exit delay countdown), ENTRY PRE-ALARM tone (entry time delay countdown), and CONFIRMATION/ERROR tones (see pg. 6).

To turn the KEYPAD FEEDBACK on and off:

**Push the * key, enter the digit "5",
the digit "1", and push the # key.**



Options

KEYPAD TONE DISABLE (Continued)

To turn the ENTRY/EXIT PRE-ALARM tones (entry/exit delay countdown) on and off:

Push the * key, enter the digit "5",
the digit "2", and push the # key.



To turn the CONFIRMATION/ERROR tones on and off:

Push the * key, enter the digit "5",
the digit "4", and push the # key.



Testing your system

LOCAL SYSTEM TEST

This option allows on-site testing of each zone in your system.

To initiate the LOCAL SYSTEM TEST:



Enter your PIN (if required),
push the * key, enter the digit "6",
the digit "0", then push the # key.

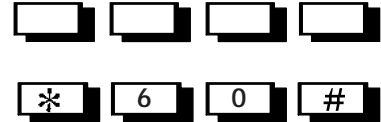

- Once the keypad lights go out, the system will be ready for testing. Walk through the areas protected by motion sensors; open and close protected doors and windows. Each time a zone is faulted, its corresponding red ZONE light on the keypad will begin flashing, and the keypad will chime.
- To exit the system test, push any key.



WARNING: Your alarm system will not report alarms during the LOCAL SYSTEM TEST.

Testing your system

OPTION
INSTALLED

STANDBY BATTERY TEST

Your alarm system can be programmed to automatically test its standby battery every 24 hours. During the test, AC power is turned off in order to monitor the battery under load.

- To manually test the standby battery, push the * key, enter the digit "6", the digit "4", then push the # key.

*** 6 4 #**

- The standby battery test takes 2 minutes. During the test, the POWER light will be off.
- If the battery is okay, the keypad will beep twice.
If the battery is low or dead, the POWER light will flash slowly, the SERVICE light will be on steady, and the keypad will beep five times.

OPTION
INSTALLED

BELL/SIREN TEST

To test the bells/sirens in your security system:

Enter your PIN (if required), push the * key, enter the digit "6", the digit "3", then push the # key.

*** 6 3 #**

PIN
REQUIRED

- The bell/siren and keypads will sound for 3 seconds.

Testing your system

OPTION
INSTALLED

CENTRAL STATION TEST

This option tests the reporting capability of your system by sending a test message to the central station. Weekends are the best time for the CENTRAL STATION TEST. To schedule one, call our central station at:

CENTRAL STATION 

To initiate the CENTRAL STATION TEST:

PIN
REQUIRED

**Enter your PIN (if required),
push the * key, enter the digit "6",
the digit "1", then push the # key.**

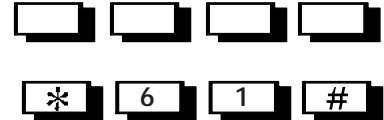

- If the test message was successfully transmitted to the central station, the keypad will beep twice.
- If the test message was not successfully transmitted to the central station, the keypad will beep five times, and the SERVICE light will flash fast. Call our Service Department for assistance.

Telephone trouble

IF YOU HAVE TELEPHONE TROUBLE:

First, unplug the control panel from its telephone jack to determine if the alarm system is causing the trouble.

The phone jack is located _____ .

If the trouble goes away when you unplug the control, call us for service. If you still have telephone trouble after unplugging the alarm system, plug the system back in, then call your **telephone company**.







NOTE: If your telephone system is serviced, make sure to test your alarm system to insure that it has not been disconnected from the telephone network.

Smoke detector placement

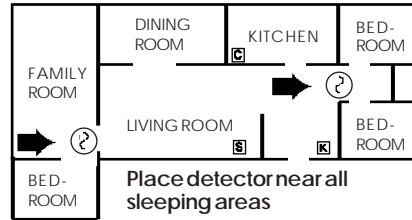
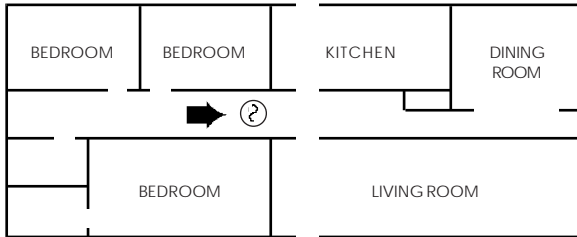
We subscribe to the recommendations for the number and placement of smoke and/or heat detectors found in the National Fire Protection Association's *Standard #72, Chapter 2* (N.F.P.A. Batterymarch Park, Quincy, MA 02269). For the best early warning, fire detection devices should be installed in all rooms and areas of the premises. A smoke detector should be installed in each separate sleeping area, in the vicinity of bedrooms. (In new construction, a smoke detector shall be installed in each separate sleeping room.) Heat or smoke detectors should be installed in living rooms, closets, utility and storage rooms, basements, and attached garages.

Best residential detector placement between bedrooms and the rest of the house



-  = SMOKE DETECTOR
-  = CONTROL
-  = SANDER
-  = KEYPAD

Place detectors near top of stairwells

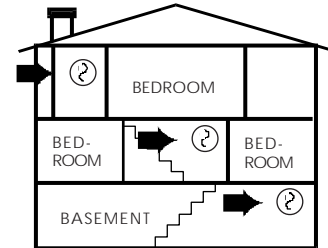

Emergency evacuation

Every household should establish and regularly practice an escape plan in the event of a fire. The following steps, recommended by the National Fire Protection Association, can be used as a guide in developing your own emergency plan.

- Plan on your detector or alarm system sounders waking all occupants.
- Determine two means of escape from each room, especially the bedrooms, since most fires occur at night when everyone is asleep. One escape path should lead to a door that permits normal exit from the house. The other may be an easily opened window (used if the primary escape path is blocked).
- Sketch a floor plan, showing doors, windows, stairs, and rooftops that can be used for escape. Indicate escape routes for each room (see examples below). Post copies of the sketch in each room. Remember to keep all escape routes free from obstruction.
- Keep all bedroom doors shut while the occupants are asleep. This will prevent deadly smoke from entering the rooms while you escape.
- Establish a meeting place outdoors, away from the house, where everyone can gather and account for those missing. Choose someone to notify the authorities. Choose someone to ensure that nobody returns to the house. **Many die going back inside.**
- Escape quickly. But don't panic.
- Before you open a door, check to see if it's hot. If it is hot, don't open it. Use an alternate escape route. Even if the door is cool, use your shoulder to open it cautiously. Be ready to slam it closed if heat or smoke rushes in.
- When moving through a smoky area, stay as close to the floor as possible. Crawl and hold your breath.

SAMPLE
FIRST FLOOR

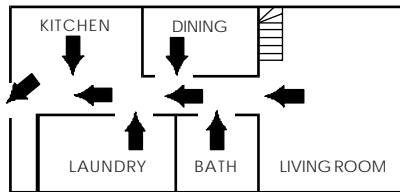

SAMPLE
SECOND FLOOR

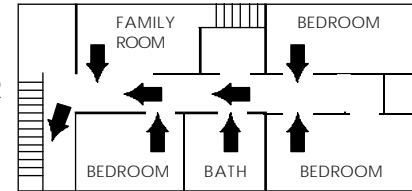

Definitions

ALARM

A condition that occurs when the detection devices in a zone are triggered after the system is armed.

ALARM MEMORY

Alarm conditions are stored in memory until cleared.

BYPASS

To take a zone out of the circuit. Bypassing malfunctioning zones allows the rest of the system to be armed. Bypassing interior zones allows freedom of movement inside the premises, while leaving outer zones armed. Bypassed zones are not protected.

CENTRAL STATION

The office that the alarm system calls when there is an alarm. Signals sent to the central station contain information about the nature of the alarm condition, allowing the dispatcher on duty to appropriately respond.

ENTRY DELAY

The time you have to enter the premises through a designated DELAY DOOR and disarm the panel (before an alarm occurs). The delay time is programmable from 10 seconds to 150 seconds. [Note: if this option is programmed for *Long Delay*, the delay time will be doubled (from 20 to 300 seconds).]

EXIT DELAY

Once the system is armed, the time you have to exit the premises through a DELAY DOOR (before an alarm occurs). The delay time is programmable from 10 seconds to 150 seconds.

FAULT

A trouble condition that occurs when the detection devices in a zone are violated or malfunctioning while the system is disarmed.

GRADE "A"

System that provides supervision of the transmitter or initiating devices (i.e., detection devices and wiring).

PERSONAL IDENTIFICATION NUMBER (PIN)

The combination used to arm and disarm the control panel, and to access any of the special functions that require a combination. PIN numbers must be four digits long.

ZONE

One of the protected areas in your premises.

24-HOUR ZONE

A zone that is always active, whether the system itself is armed or disarmed. FIRE, POLICE, and EMERGENCY zones are usually 24-hour zones. Alarm conditions on these zones are cleared by entering a valid PIN number.

Limitations

THE LIMITATIONS OF YOUR ALARM SYSTEM

While your alarm system is reliable and sophisticated, it does not offer guaranteed protection against burglary or fire. Any alarm system, whether commercial or residential, is subject to compromise or failure-to-warn for a variety of reasons. These include:

- Intruders may gain access through unprotected openings or have the technical sophistication to bypass an alarm sensor or disconnect an alarm warning device.
- Intrusion detectors, smoke detectors, and many other detection devices will not operate without power. Devices powered by AC will not work if their AC power supply is off for any reason and their back-up batteries are missing, dead, or improperly installed.
- Alarm warning devices such as sirens, bells, and horns may not alert people or wake up sleepers if they are located on the other side of closed or partly closed doors. If warning devices are on a different level of the residence from the bedrooms, they are less likely to waken or alert people inside the bedrooms.
- Telephone lines needed to transmit alarm signals from a premises to a central monitoring station may be out of service, and are subject to compromise by sophisticated means of attack.
- Smoke detectors used in conjunction with the alarm system may not sense fires that start where smoke cannot reach the detectors, such as in chimneys, walls or roofs, or on the other side of closed doors. Smoke detectors also may not sense a fire on another level of the residence or building. A second floor detector, for example, may not sense a first floor or basement fire. Finally, smoke detectors have sensing limitations. No smoke detector can sense every kind of fire every time. In general, detectors may not always warn you about fires caused by carelessness and safety hazards, like smoking in bed, violent explosions, escaping gas, improper storage of flammable materials, overloaded electrical circuits, children playing with matches, arson, etc.
- The most common cause of an alarm system not functioning properly when an intrusion or fire occurs is **inadequate maintenance**. Your alarm system should be tested weekly to make sure all detection devices are operating properly. Your control panel and keypads should be tested as well.
- Installing an alarm system may make you eligible for lower insurance rates, but an alarm system is not a substitute for insurance. Homeowners, property owners, and renters should continue to insure their lives and property.

Keypad operations

For your convenience, the following is a list of the keypad operations discussed in these instructions.

KEYS

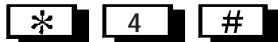
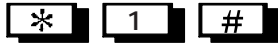
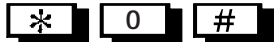

FUNCTIONS

Arms and Disarms the system

Programs new user PINs (Master PIN required).

Clears the alarm memory and Watchdog Reset (Service Light)

Bypasses individual zones (PIN may be required).

Arms the system with interior zones bypassed (PIN may be required).

Converts Entry time delay zones to INSTANT (if programmed to do so), and arms perimeter zones, while bypassing interior zones (PIN may be required). Refer to Instant Home Arming on page 13.

Keypad operations

KEYS

* 5 #

* 5 1 #

* 5 2 #

* 5 4 #

* 6 0 #

* 6 1 #

* 6 2 #

FUNCTIONS

Turns the Door Chime on/off (on all keypads).

Turns the audible Keypad Feedback on/off.

Turns the Entry/Exit Pre-Alarm tones on/off.

Turns the Error tones on/off.

Initiates the Local System Test (PIN may be required).

Initiates the Central Station Test (PIN may be required).

Resets Smoke Detectors.

Keypad operations

KEYS

* 6 3 #

* 6 4 #

* 7 #

* 7 4 #

FUNCTIONS

Initiates the Bell/Siren Test (PIN may be required).

Initiates the Standby Battery Test.

Converts all time delay zones to INSTANT and arms the system (PIN may be required).

Converts Entry time delay zones to INSTANT (if programmed to do so), and arms perimeter zones, while bypassing interior zones (PIN may be required). Refer to Instant Home Arming on page 13.

Test procedures index

As required by UL Standard 1023, your alarm system is a Grade "A" system (see definition on page 31).

Alarm system malfunctions and failures are caused most often by INADEQUATE MAINTENANCE.

Your alarm system should be tested weekly to make sure that all detection devices are working properly. In addition, if your system is being monitored, you should periodically test its ability to transmit signals to our central station.

These tests should be performed weekly:

• LOCAL SYSTEM TEST: Enter PIN (if required), then

***** **6** **0** **#**

• CENTRAL STATION TEST: Enter PIN (if required), then

***** **6** **1** **#**

• BELL/SIREN TEST: Enter PIN (if required), then

***** **6** **3** **#**

• STANDBY BATTERY TEST:

***** **6** **4** **#**

Refer to pages 25 - 27 for further information on test procedures.

Zone description list

ZONE	LOCATION	BYPASS	
		YES	NO
1			
2			
3			
4			
5			
6			

FCC NOTICE

WARNING: This device is intended to be installed by a professional alarm installer.

The user shall be cautioned that changes or modifications not expressly approved by C&K SYSTEMS could void the user's authority to operate the equipment.

FCC Rules PART 15

This equipment has been tested and found to comply with the limits for Class B digital devices, pursuant to Part 15 of the FCC Rules. These limits are designed to provide reasonable protection against harmful interference in a residential installation.

This equipment generates, uses, and can radiate radio frequency energy, and if not installed and used in accordance with the instructions, may cause harmful interference to radio communications. However, there is no guarantee that interference will not occur in a particular installation.

If this equipment does cause harmful interference to radio or television reception, which can be determined by turning the equipment off and on, the user is encouraged to try to correct the interference by one or more of the following measures:

- Reorient the radio/television antenna.

- Connect the AC transformer to a different outlet so that the control panel and radio/television are on different branch circuits.

- Relocate the control panel with respect to the radio/television.

- Consult the dealer or an experienced radio/television technician for help.

FCC Rules PART 68

This equipment has been tested and found to comply with Part 68 of the FCC Rules. On the left outside panel of the can is a label that contains the FCC registration number and the Ringer Equivalence Number (REN) for this equipment. This information must be provided to your telephone company, if requested. The REN may be used to determine the maximum number of devices which may be connected to your telephone line and still have all devices ring properly when your number is called. The maximum sum of all devices should not exceed 5. This number may be different in your area. Contact your local telephone company to determine the maximum REN for your calling area.

Should you experience trouble with the telephone lines, disconnect the panel from the line to determine the source of the trouble. If it is determined that the control panel is malfunctioning, discontinue its use until the malfunction has been corrected. Any repairs or alterations made by the user to this equipment, or equipment malfunctions, may give the telephone company cause to request the user to disconnect the equipment. Repairs to this equipment should be made by an authorized agent of C&K SYSTEMS, Inc. Contact your local alarm installation company for service.

Should this equipment cause harm to the telephone system, the telephone company may temporarily discontinue your service. If possible, they will provide you with advance notice. Otherwise they will notify you as soon as possible. The telephone company will also advise you of changes in its facilities, equipment, operations or procedures which could affect the operation of your equipment, allowing you the opportunity to maintain uninterrupted service. You will also be advised of your right to file a complaint with the FCC.

This device must not be used on party lines or coin operated phone lines.

Industry Canada

NOTICE: The Canadian Department of Communications label identifies certified equipment. This certification means that the equipment meets certain telecommunications network protective, operational and safety requirements. Industry Canada does not guarantee the equipment will operate to the user's satisfaction.

Before installing this equipment, users should ensure that it is permissible to be connected to the facilities of the local telecommunications company. The equipment must also be installed using an acceptable method of connection. In some cases, the company's inside wiring associated with a single line individual service may be extended by means of a certified connector assembly (telephone extension cord). The customer should be aware that compliance with the above conditions may not prevent degradation of service in some situations.

Should you experience trouble with the telephone lines, disconnect the panel from the line to determine the source of the trouble. If it is determined that the control panel is malfunctioning, discontinue its use until the malfunction has been corrected. Any repairs or alterations made by the user to this equipment, or equipment malfunctions, may give the telephone company cause to request the user to disconnect the equipment. Repairs to this equipment should be made by an authorized agent of C&K SYSTEMS, Inc. Contact your local alarm installation company for service.

Users should ensure for their own protection that the electrical ground connections of the power utility, telephone lines and internal metallic water pipe system, if present, are connected together. This precaution may be particularly important in rural areas.

Caution: Users should not attempt to make such connections themselves, but should contact the appropriate electric inspection authority, or electrician, as appropriate.

The Load Number (LN) assigned to each terminal device denotes the percentage of the total load to be connected to a telephone loop which is used by the device, to prevent overloading. The termination on a loop may consist of any combination of devices subject only to the requirement that the total of the Load Numbers of all devices does not exceed 100.

This digital apparatus does not exceed the Class B limits for radio noise emissions from digital apparatus set out in the Radio Interference Regulations of the Industry Canada.

Le présent appareil numérique n'émet pas de bruits radioélectriques dépassant les limites applicables aux appareils numériques de la Class B prescrites dans le Règlement sur le brouillage radioélectriques édicté par Industrie Canada.

Printed in Hong Kong
5-051-371-00 Rev D

C&K is a registered trademark of C&K
Components, Inc.

Copyright 1995 C&K SYSTEMS, Inc.
All Rights Reserved

